

### Installation Sequence ① ② ③ ..... ⑮

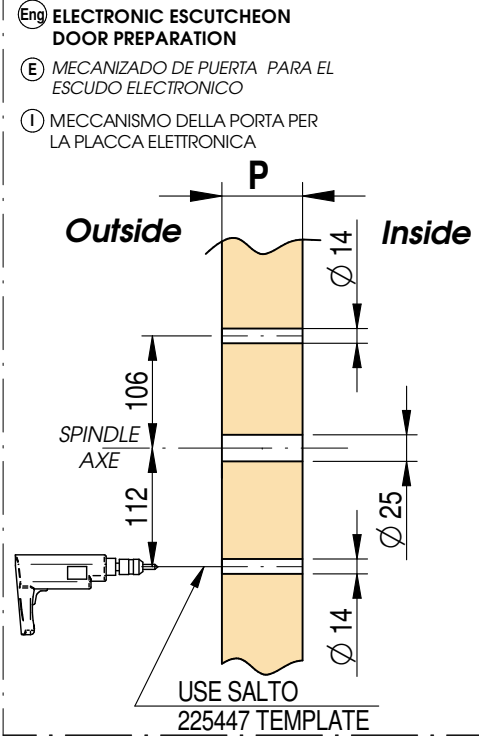

FOR ELECTRONIC ESCUTCHEON

	(1) M5 x Length DIN 7985
	(1) M5 x Length DIN 7991
	(1) Ø8.9x19 DIN 7504
	(?) BOLT EXTENSION

P Door / Puerta mm	Length mm	BOLT EXTENSION SUPLEMENTO
35-43	30	-
44-53	40	-
54-63	50	-
64-68	55	-
69-75	30	1
76-85	40	1
86-94	50	1
95-99	55	1
100-106	30	2
107-116	40	2
117-120	50	2

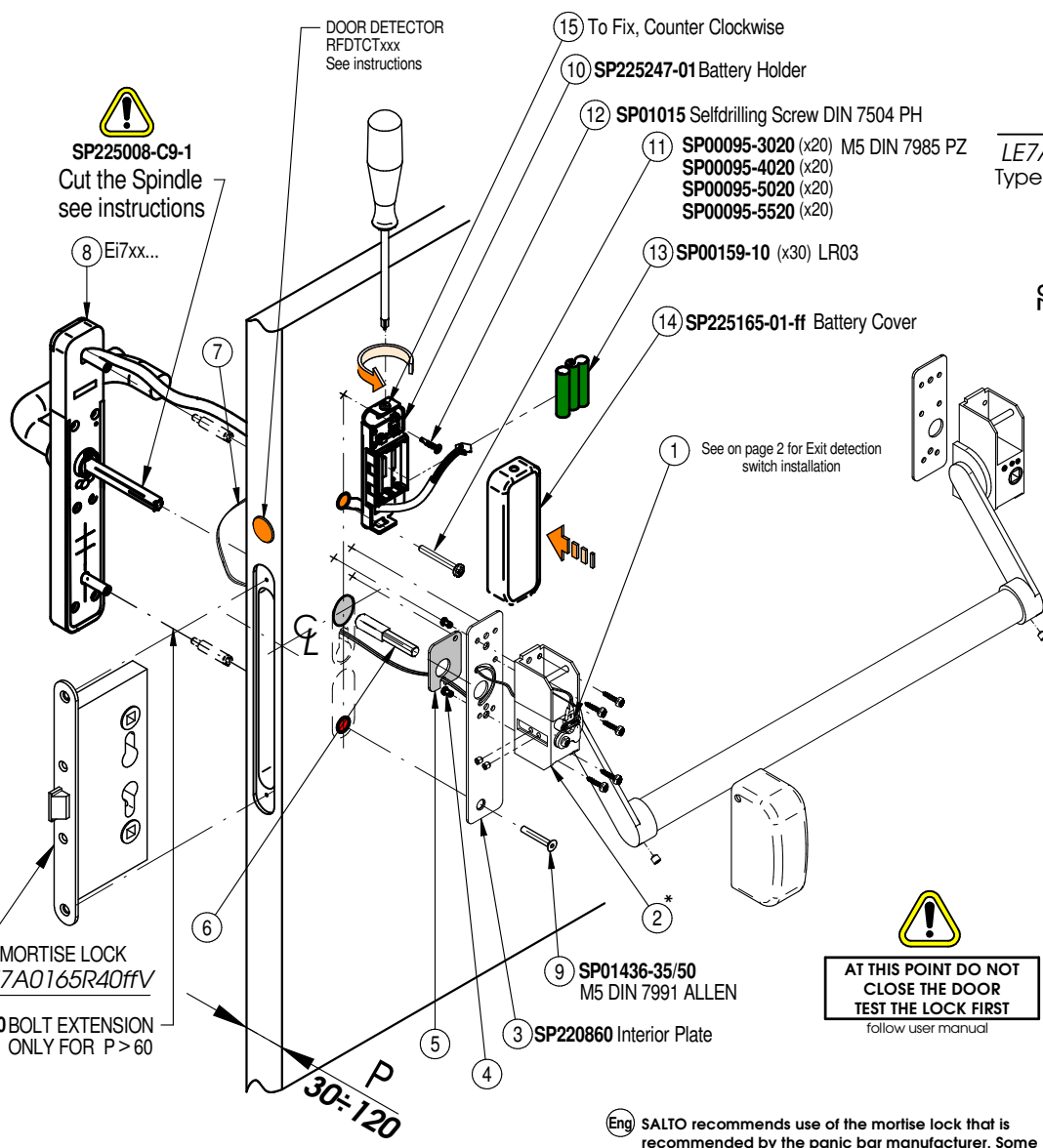

### EXTERNAL ELECTRONIC ESCUTCHEONS

Eng LOCKS	Eng COMPATIBLE MODELS
E CERRADURAS	E MODELOS COMPATIBLES
I SERRATURE	I MODELLO COMPATIBILE
LE7A0165R40ffV Type RF FIRE - 72 PZ	Ei750x7FxxH9x Ei754x7FxxH9x
	ONLY 9mm SPINDLE

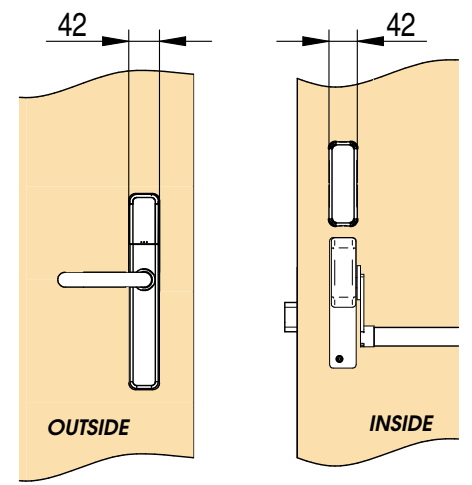

**AT THIS POINT DO NOT CLOSE THE DOOR TEST THE LOCK FIRST**  
follow user manual

**Eng \* SEE PBA<sup>®</sup> 120020 PANIC BAR INSTALLATION INSTRUCTIONS**

**E \* MONTAJE BARRA ANTIPANICO PBA<sup>®</sup> 120020 SEGUN INSTRUCCIONES DEL FABRICANTE**

**I \* MONTAGIO MANIGLIONI ANTIPANICO PBA<sup>®</sup> 120020 SECONDO LE ISTRUZIONI DEL FABRICANTE**

**Eng SALTO recommends use of the mortise lock that is recommended by the panic bar manufacturer. Some automatic locks can cause problems. Only Wireless Models: -Locks with split hub, switch must be installed for exit detection.**

**E SALTO no garantiza el correcto funcionamiento del ensamble, si no se utiliza la cerradura recomendada por el fabricante. Especialmente con cerraduras automáticas. Sólo Modelos Wireless: - Cerraduras con nueva partida, deben de montar el switch en la cabeza de la barra para detección de salida.**

### Spindle cutting instructions

- Eng MORTISE LOCK WITH SPLIT HUB
- E CERRADURA CON NUECA PARTIDA
- I SERRATURA PERNO QUADRO

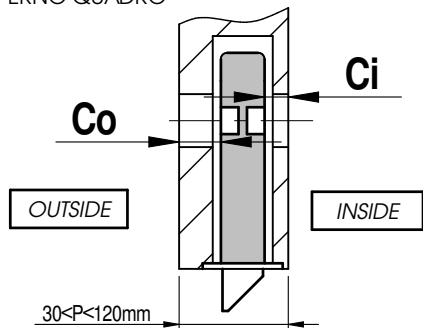

#### 1 Escutcheon Outside Spindle

- E Cuadrillo Exterior escudo electronico
- I Qadra esterno maniglia elettronica

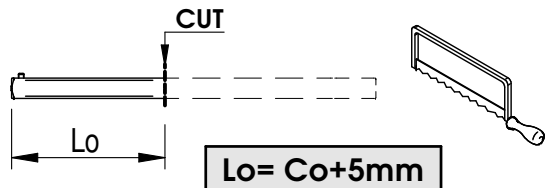

#### 2 Panic Bar Inside Spindle

- E Cuadrillo Interior barra antipánico
- I Qadra Interno maniglioni antipánico

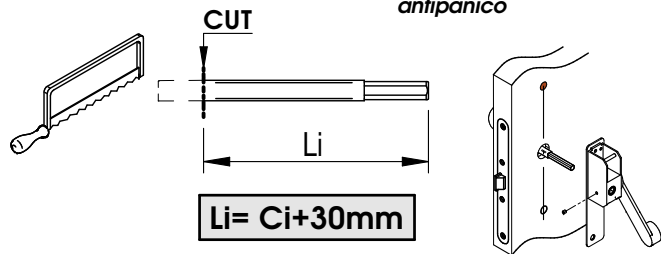

Eng \* SEE PBA® 120020  
PANIC BAR INSTALLATION  
INSTRUCTIONS

E \* MONTAJE BARRA ANTIPÁNICO  
PBA® 120020 SEGÚN  
INSTRUCCIONES DEL FABRICANTE

I \* MONTAGIO MANIGLIONI  
ANTIPANICO PBA® 120020 SECONDO  
LE ISTRUZIONI DEL FABRICANTE

### Exit detection switch Installation

